

Product information

REF 450-P



REF 450-P

TRACOE *vario* Tracheostomy Tube

with minimally traumatic insertion system, spiral-reinforced, adjustable neck flange, low pressure cuff, scale and 15 mm connector

- Including:
- ◆ lubricating gel
 - ◆ obturator and neck strap
 - ◆ in sterile package

As percutaneous set in REF 420

Highly Adaptable



The TRACOE *vario* tube has a patented adjustable neck flange. By means of a practical push-button mechanism, the flange can be moved along the tracheostomy tube and adjusted to the individual patient. The flange is fixed securely in position by moving the orange locking lever upwards. Since no screw closure is used, no pressure at all is exerted on the trachea.

The flexible wings of the TRACOE *vario* neck flange can be adjusted independently, providing further opportunities to accommodate the individual patient's anatomy.

Scope of Supply of TRACOE *vario* and *vario* XL Tubes

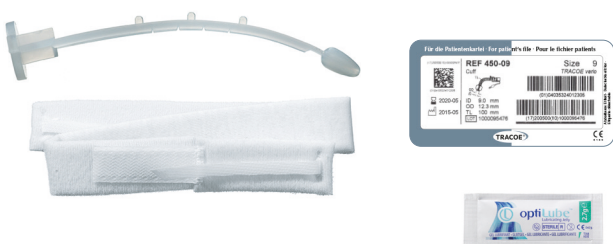

All TRACOE *vario* tubes are supplied with an obturator, a wide adjustable neck strap (REF 903-F), and a product info card with two detachable labels.

Lubricating gel is also supplied with the *vario* P-tubes.

Product information

REF 450-P

The Innovation

The Feature of the TRACOE experec Set *vario* is the minimally traumatic Insertion System of the Tubes. The system consists of two parts: the guiding catheter with silicone sleeve and the inserter for stabilisation and guidance of the tube. The silicone sleeve smoothly bridges over the gap in diameter between the end of the tube and the inserter thus minimising the risk of injury when inserting the tracheostomy tube into the trachea. The insertion system excels with a precise fit into the tube and a stop at the 15 mm connector. Once the tube is in the trachea first the inserter is removed and only then the guiding catheter with silicone sleeve. By doing so the silicone sleeve flaps back and the guiding catheter can be removed easily. The Seldinger guide wire can be removed either prior or together with the guiding catheter. Under no circumstances the guiding catheter must be removed first.

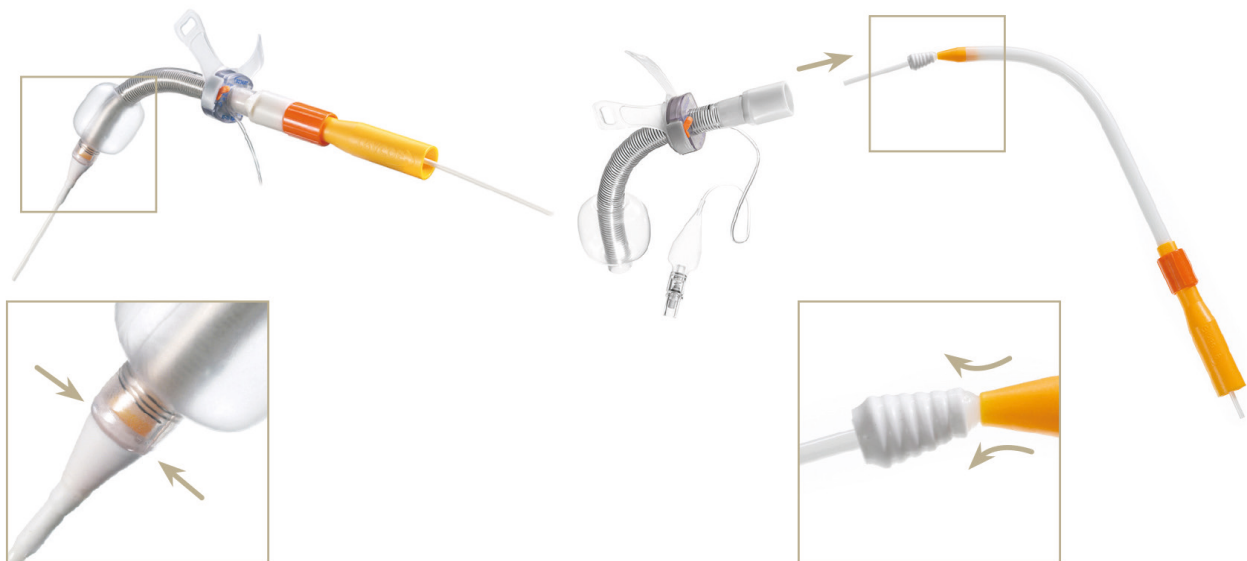

The Benefits

- Dilation is performed using the proven Ciaglia one-step technique.
- The minimally traumatic insertion system smoothes over the gap in diameter between the end of the tube and the inserter. This minimises the risk of injury when inserting the tracheostomy tube into the trachea.
- The stop at the 15 mm connector prevents the inserter from being inserted too far into the tube, which additionally reduces the risk of injury.
- The separately available tubes with insertion system can also be used for reinsertion into a percutaneously created tracheostoma and/or change tubes; if necessary in combination with the Seldinger guide wire.

Product information

REF 450-P

Technical data

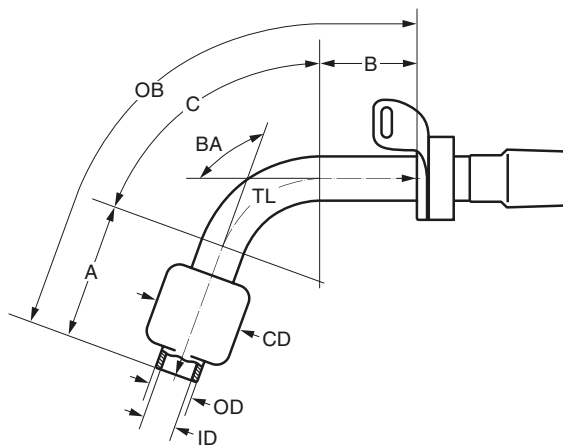

REF 450, REF 455, REF 460 *in sizes 06 – 11*
 REF 464 *in sizes 07 – 09*
 REF 470 *in sizes 07 – 10*
 REF 450-P, REF 460-P *in sizes 07 – 09*
 REF 470-P *in sizes 08 – 09*

Size	ID mm	OD mm	A mm	C mm	B mm	TL mm	OB mm	BA e°	CD mm
06	6.0	8.2	30	28	12	70	76	100	18
07	7.0	9.7	33	32	15	80	86	100	22
08	8.0	11.2	35	35	20	90	97	100	28
09	9.0	12.3	38	35	27	100	106	100	30
10	10.0	13.7	38	37	35	110	120	100	32
11	11.0	14.8	38	37	35	110	121	100	34

ID: inside diameter (clear width) at bottom of cannula; **OD:** outside diameter at bottom of cannula; **A:** length; **C:** length;
B: length; **TL:** length along centre line; **OB:** length along outer bend; **BA:** bending angle; **CD:** cuff diameter

To order, specify **REF + size**, e.g. **REF 450-08**

Accessories

Heat/Moisture Exchangers, HME

- ◆ TRACOE humid assist I REF 640-CT
- ◆ TRACOE humid assist III REF 641
- ◆ TRACOE humid assist VI REF 642

For the Cuff Pressure Management

- ◆ TRACOE smart Cuffmanager REF 730-5
- ◆ TRACOE cuff pressure monitor (cpm) REF 720
- ◆ TRACOE cuff pressure monitor sensitive (cpms) REF 721

REF 450 without minimally traumatic insertion system

This tube is also available without minimally traumatic insertion system.